



shaping tomorrow with you

Ticket & Label Printing FP-32L



FP-32L Information

■ Label printer Market

Production in 2014 (Global)

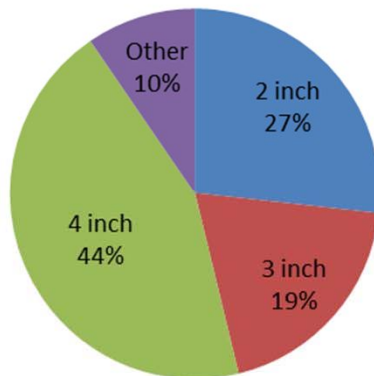

Print Width (inch)	Production (Kunits)
2 inch	1,398
3 inch	1,017
4 inch	2,313
Other	500
Total	5,228

QY Research April, 2015

Global Market share of label printer

4 inch (print width) is main occupation in the global market of label printer.

⇒ The target of FP-32L is 2 inch or 3 inch (print width) which are occupied 46% of global market.

■ FP-32L and other Label printers

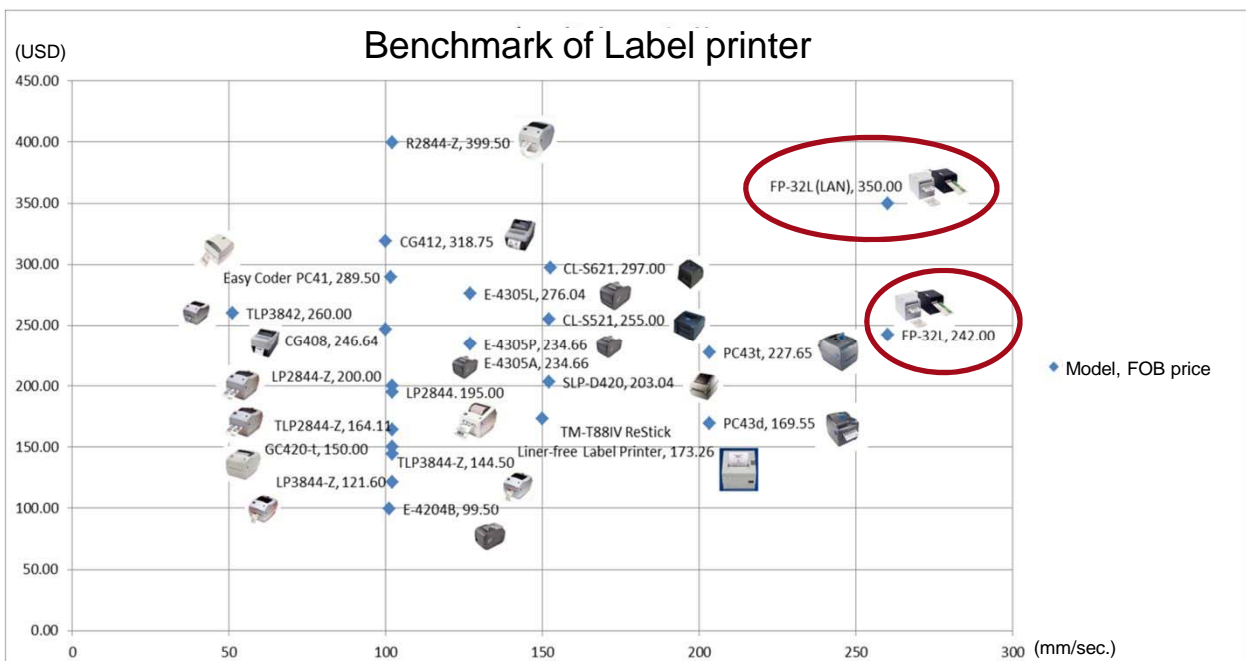

■ Time shortening



Feature1: Setting paper

Paper setting is **"Drop-in Paper set"**.

You can finish the setting paper in a moment.
Just throw the paper inside of the printer.

Feature2: Speed

FP-32L doesn't keep you waiting for printing !!

Max. printing speed is **260mm/sec.**

FP-32L helps your operation smoothly.

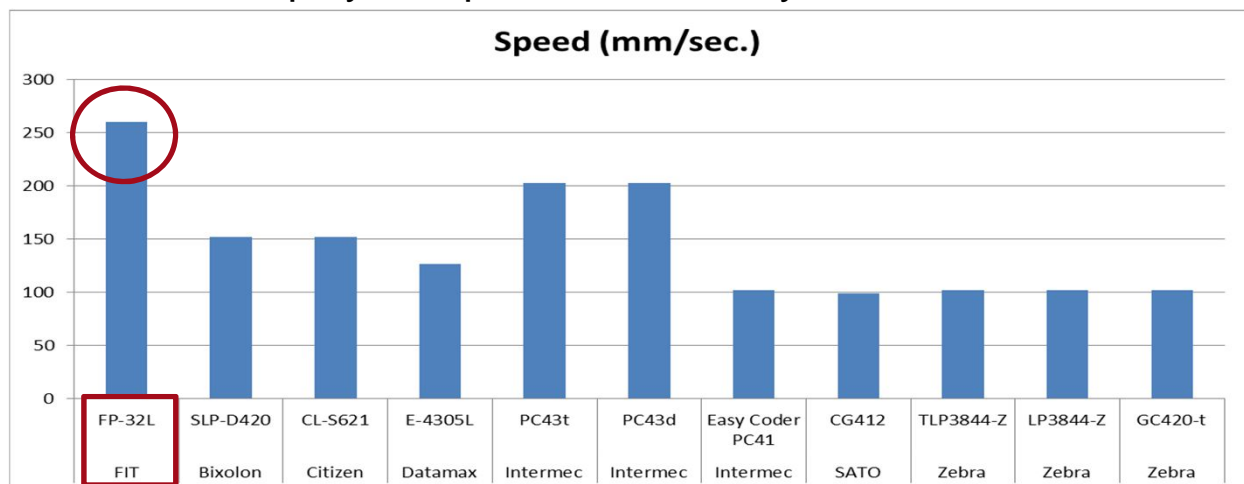

■ Installing anywhere

Feature1: Compact

The dimensions are

128mm(W), 207mm(D), 145mm(H).

You can install even tiny space.



Feature2: Splash-Proof

FP-32L applies **Splash-proof design.**

*IEC60529(Level2) Conformance

You can use even wet environment like kitchen.



■ Flexible for various kinds of papers



Label Printing

~ FP-32L can print various size of label ~

Point1: Paper width
You can change the label width depending on usage.



1 inch ~ 3 inch

Point2: Roll Paper Unit (option)
It can help to print for roll paper with big diameter up to **200mmΦ**





Ticket Printing

~ FP-32L can print large amount of tickets~

Point1: Fanfold Paper





FP-32L is flexible for “**Fanfold paper**” for printing large amount of tickets smoothly.

Of course!!
FP-32L can print the paper with **Black Mark sensor** and **Transmissive sensor** .



Example for business scenes

Healthcare
Manufacturing
Logistics
Foods



Example for business scenes

Cinema, Concert
Amusement Park
Boarding tickets
Airline, Logistics, Manufacturing

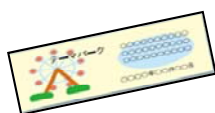

■ Other Features

Feature1: A variety of Interface for your needs

You can choose interface depending on the intended use in your business.



RS232C (25pin)



USB (2ports)



Dual (25pin serial)



LAN

*Powered USB (under developing)

*Bluetooth (under developing)

If you are interested in them, please contact us.
FIT can customize the printer for your request.

Feature2: Easy Maintenance

The print method of FP-32L is direct thermal printing.
You can save...



The cost for purchase ribbons



Complicated exchanging ribbons for the maintenance



Feature3: High reliability

150 km

Print head life is 150km by high quality overcoat.

1million

Cutter life is 1 million cuts (Die-cut label).

* FIT original development and high performance cutter

70 million

MFCB is 70 million lines.

■ Case Study1: Amusement

- Printing tickets for **Amusement Park** , **Sports tickets**, and **Cinema**, etc...

Example: Boarding pass tickets for cruise in Singapore

Ticketing in convenience store in Japan

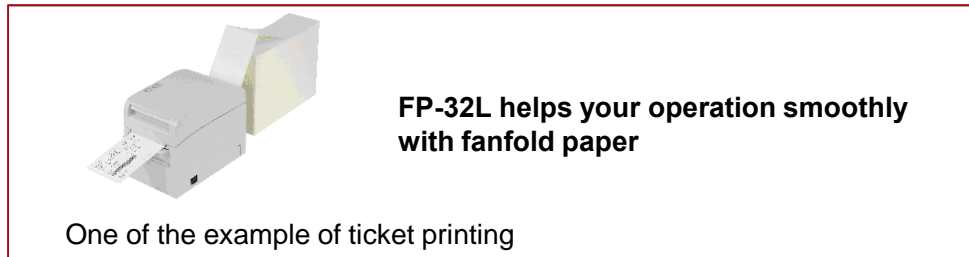

■ Case Study2: Manufacturing

- Printing labels for **packing label** and **identification tag**, etc...

Example: Manufacturing line in Japan

Product label in China

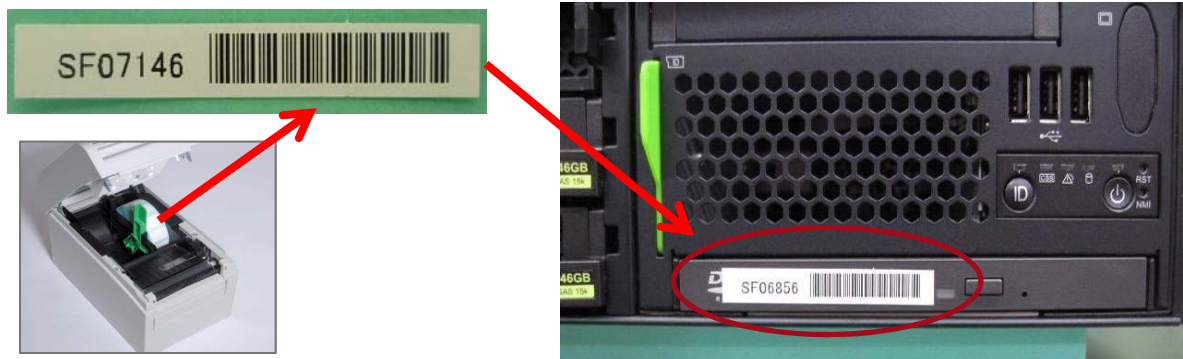

You can change the label width depending on usage.

⇒1inch ~ 3 inch

■ Case Study2: Healthcare

- Printing labels for **analyte**, **infusion** or **drug medicine** ... etc.

**Example: Academic Medical Center,
Civilian Hospital in Japan**

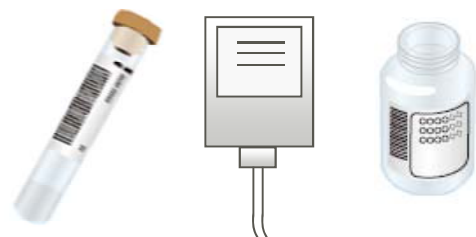

Flexible for various business scenes 2



■ Sample Print: These are samples for various scenes.

Example: Manufacturing

Ex Factory date : 20XX.XX.XX Delivery Date : 20XX.XX.XX

02 -> 03 -> 05 J72

Ship to Fujitsu Isotec Ltd.
Address 134, Higashinozaki, Hobara-machi, Qty. 1/1
Date-shi, Fukushima, Japan

Type name FP-32L Printer No. KA90909-DXXX

Order No. C9999

Shipment No. AB1234 shipping advise No. F99996

Ex-factory date: 2009-04-01 Delivery Date: 2009-04-05

01 → 03 → 05 J72

Ship to Fujitsu Isotec Ltd.
Address 135, Higashinozaki, Hobara-machi, Qty. 1/1
Date-shi, Fukushima, Japan

Type name FP-32L Printer No. KA02051-D991

Order No. C99999

Shipment No. AB1234 Shipping advise No. F99999

07

No. F999999999 01 Fujitsu Isotec

Specific C99999

No.	MODEL	PART NUMBER	QTY
1	FP-32L	KA02051-D991	1
2	FP-510	KA02041-D999	1
3	THERMAL PAPER	PD160R-80X102	1

A0123456789012346789A

Example: Healthcare

■ Hematological value 2ml
xx.xxx.20xx Division of cardiovascular

Mr. Test Test2 Male

a 0 1 2 3 4 5 6 7 8 9 0 1 2 3 4 5 6 7 8 9 a

ID: 12345567890 0123456-1

Example: Food

name	Pizza
ingredient	Wheat, Yeast, Olives, Olive oil, Tomato, Mozzarella cheese, Basil, Oregano, Onions, Capers, Sausage, Chile Peppers, Mushrooms, Anchovies
Expiration	XX-XX-20xx
Manufacturer	FIT Food Ltd. 135, Higashinozaki, Hobara-machi Date-shi, Fukushima, Japan

a 0 1 2 3 4 5 6 7 8 9 0 1 2 3 4 5 6 7 8 9 a

Example: Amusement (Ticket)

FUJITSU

No. 001234

FIT Solution Forum

● Thermal Printer System Solution

● WebPOS System Solution

Date : Xth, July, 9:00am
Place: FIT Arena

Organizer : Fujitsu Isotec Ltd.
For any queries : Sales Division

Ticket

How to use FP-32L

How to use



We would like to introduce main usage.
These are useful functions.

■ Setup of paper width (Separator of printer)

- Paper width less than 70mm → Please move Separator A to right and left.
- Paper width 80mm → Please remove Separator A.
- Paper width 83mm → Please remove Separator B



Separator A



Separator A

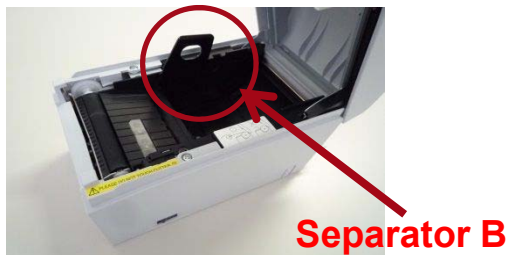

Separator B



Separator B

■ Register of paper layout (PC and Printer)

FP-32L driver provides a function that allows you to set printer layout information.

Ex: Windows7 version

Steps

1. Open the property of FP-32L driver.
2. Open the Custom Paper tab.
3. Select "Create a New Paper."
4. Fill out "Paper Name", "Paper Type", and size of paper.
5. Please click "Save" and "Transfer to Printer" after finishing inputting information.

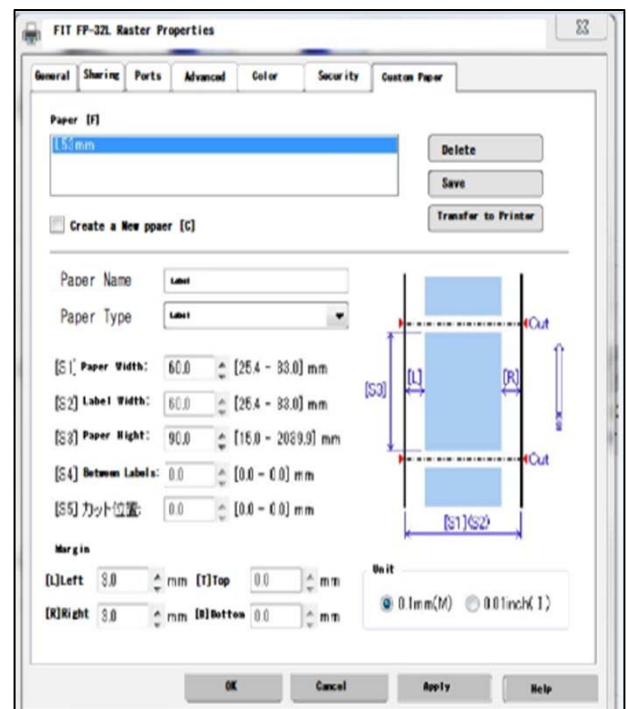



■ Automatic layout detection (Resister to printer)

FP-32L has the function to obtain paper layout information automatically.

This function can detect and register;

- **kinds of paper (Die-cut label, Black mark, receipt, label)**
- **Paper layout (length)**
- **Adjustment sensors (Die-cut label)**

Steps

1.  Setting paper
2.  Press and hold the feed button and lamp is blinking. (Cover is opened.)
3.  FP-32L starts detecting the paper layout after cover is closed

Note1: It cannot detect paper width.

Note2: The range of available printing in default is 70mm (width).

If you use the paper which is more than 70mm (width),
please setup by the property of Windows driver.

Example

You can print labels or tickets from your Excel file or Words file.

■ Printing label from Excel file

	A	B	C	D	E	F	G	H
1		Sakura Kobayashi (Ms.)						
2		Global Sales and Marketing Div.						
3		Fujitsu Isotec Ltd.						
4		Adr: 135, Higashinozaki, Hobara-machi,						
5		Date-shi, Fukushima,960-0695 JAPAN						
6		Tel: +81-24-574-2236 (COINS:7387-2594)						
7		Fax: +81-24-574-2382						
8		E-mail: kobayashi.saku@jp.fujitsu.com						
9								
10								
11								
12								
13								
14								
15								
16								
17								
18								

This label (Sample) can be printed from your Excel file.



Step1: Registering paper custom

1. Open "Start" of windows.
2. Select the "Control Panel".

*Printer Driver
Windows Driver
OPOS Driver

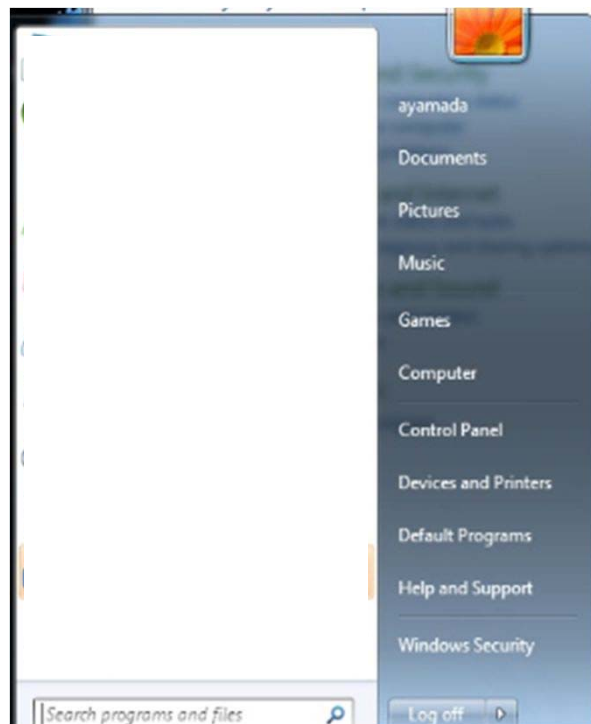

3. Select “View device and printer”

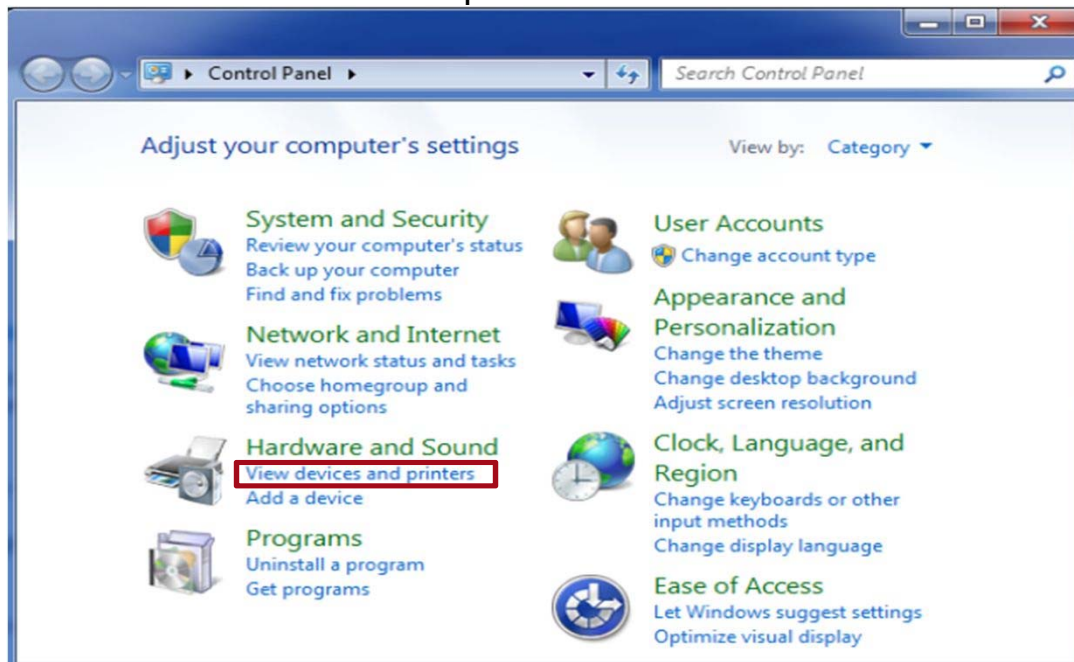

4. Right click of “FP-32L Raster”

5. Select the “Printer properties”

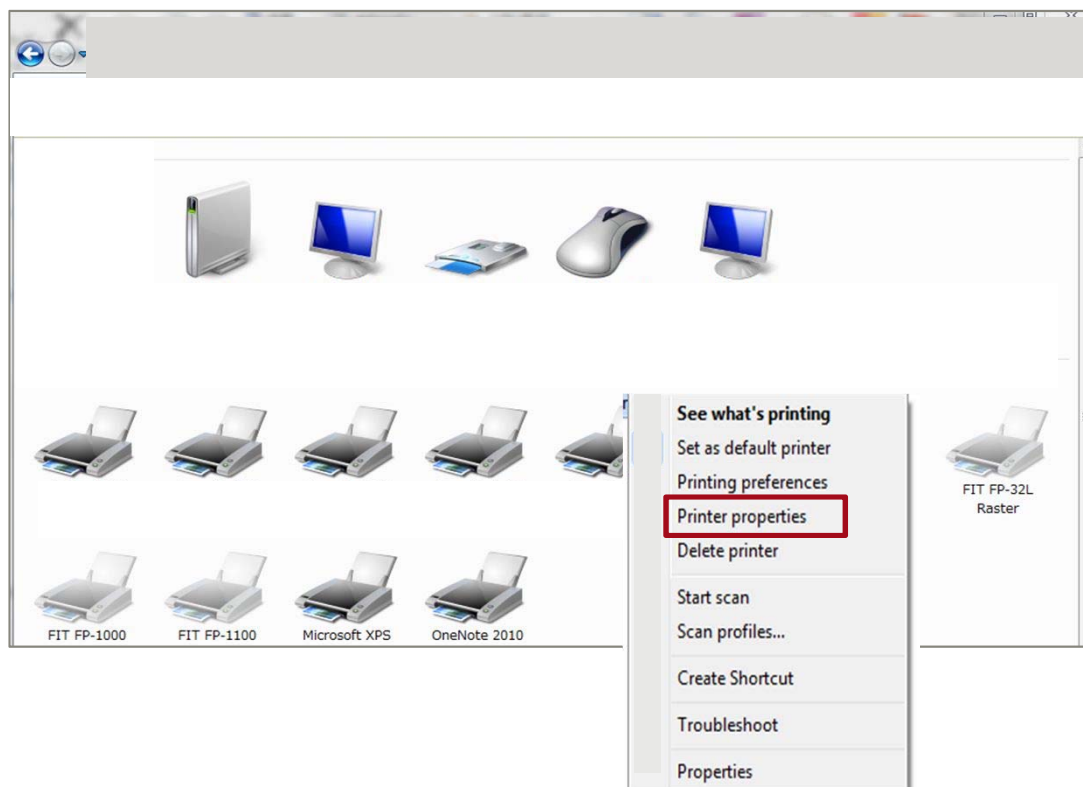

Example

6. Select "Custom Paper".
7. Check the "Create a New Paper".
8. Fill out the Paper Name.
9. Select "Paper Type".
10. Fill out "Paper Width"
11. Fill out "Paper Height"
12. Click "Save".
13. Click "Apply".
14. Click "OK".

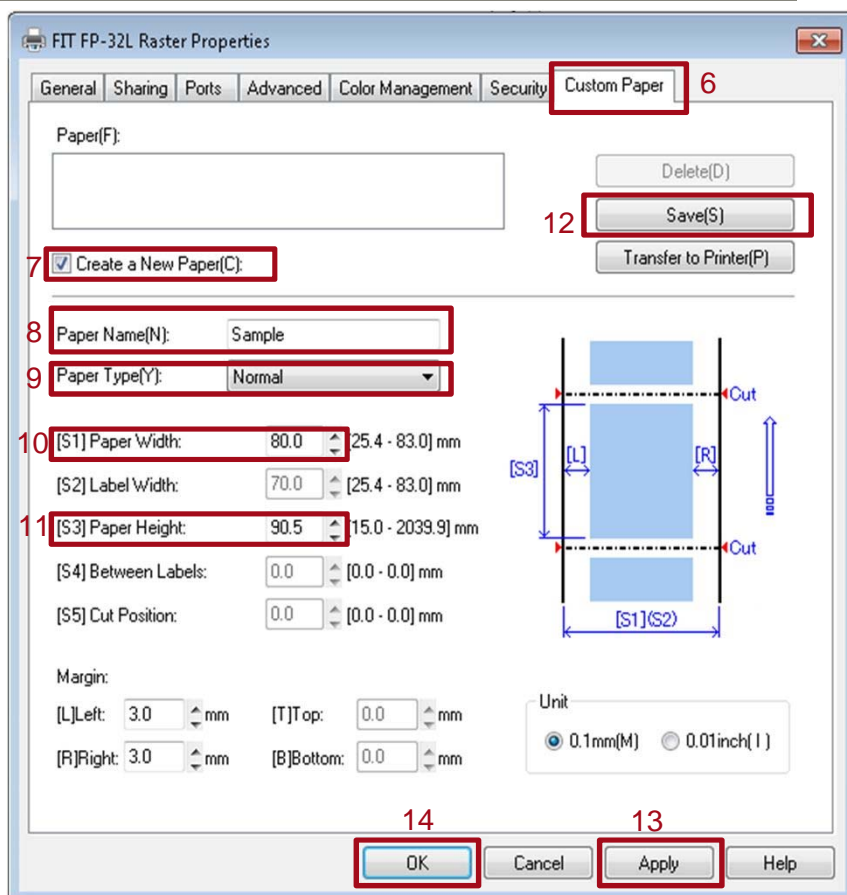

Step2: Printing from Excel file

1. Open the Excel file
2. Select "File" tab.
3. Select "Print" tab.
4. Select "FP-32L Raster" from Printer tab.
5. Select the paper name that you register in printer properties.
6. Click "Print"

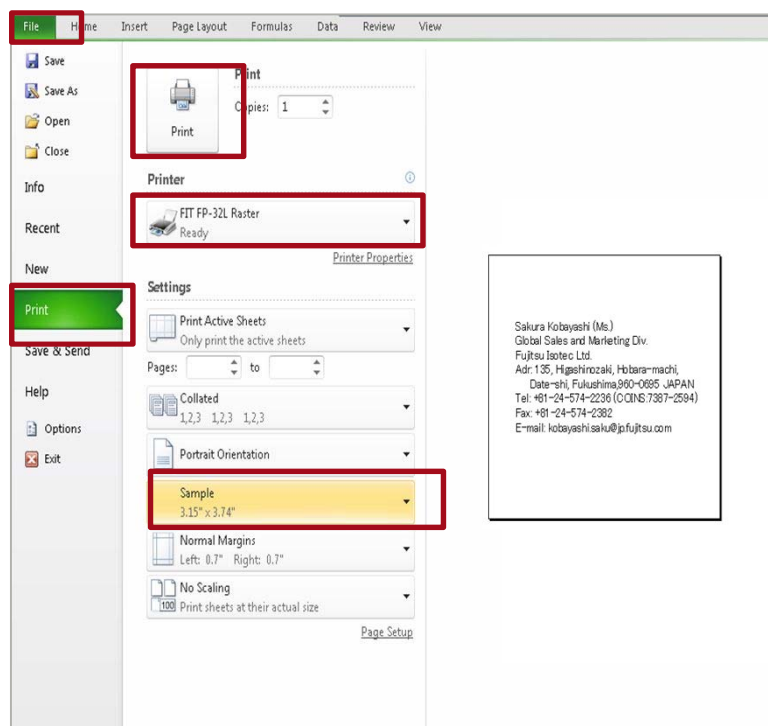

Example

※There is a possibility that the default version of margin or printing position is printed.

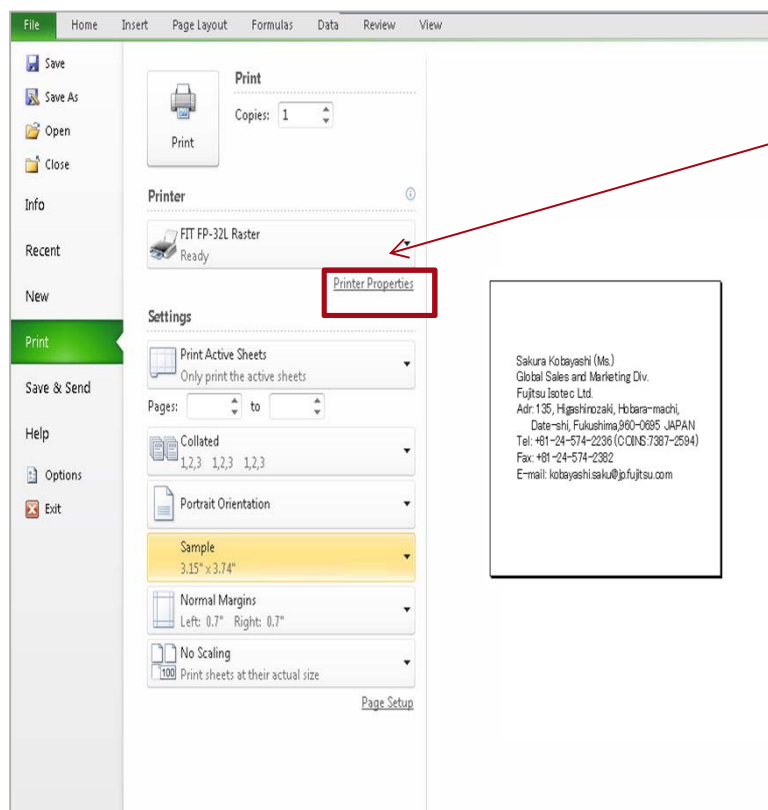

If you want to change the paper layout from the default version,

You can change the details from "Printer Properties" in Excel file.

<The method of changing details in Printer Properties in Excel file>

1. Click “Printer Properties”

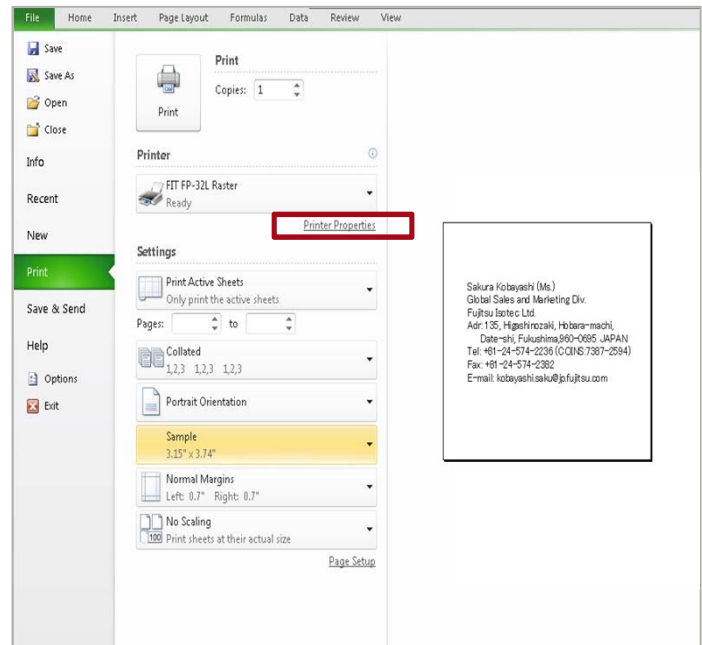

2. Click
“Paper cut and Paper feed”

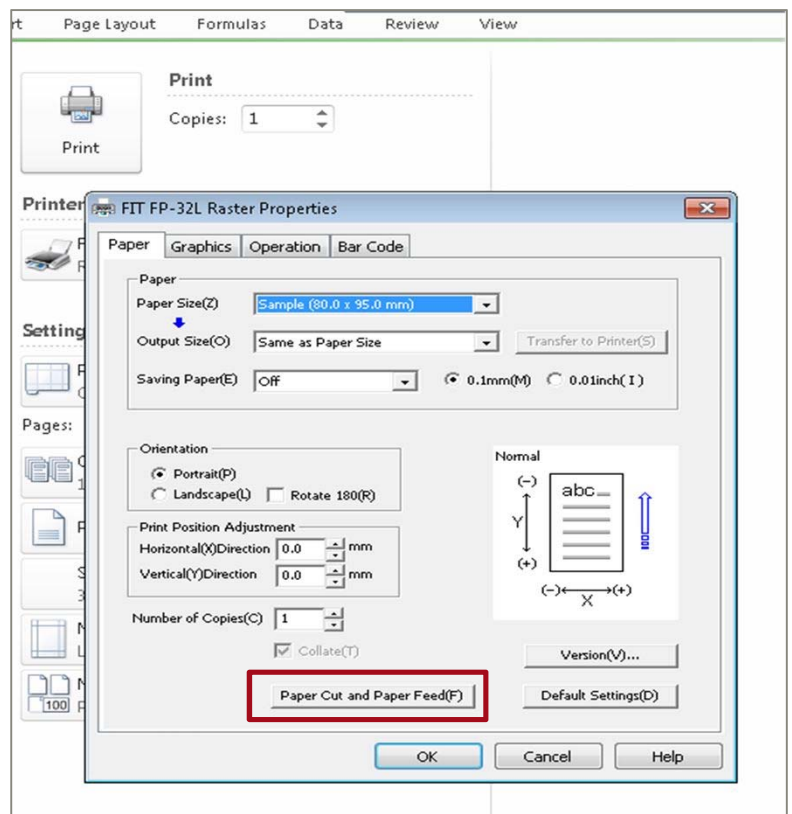

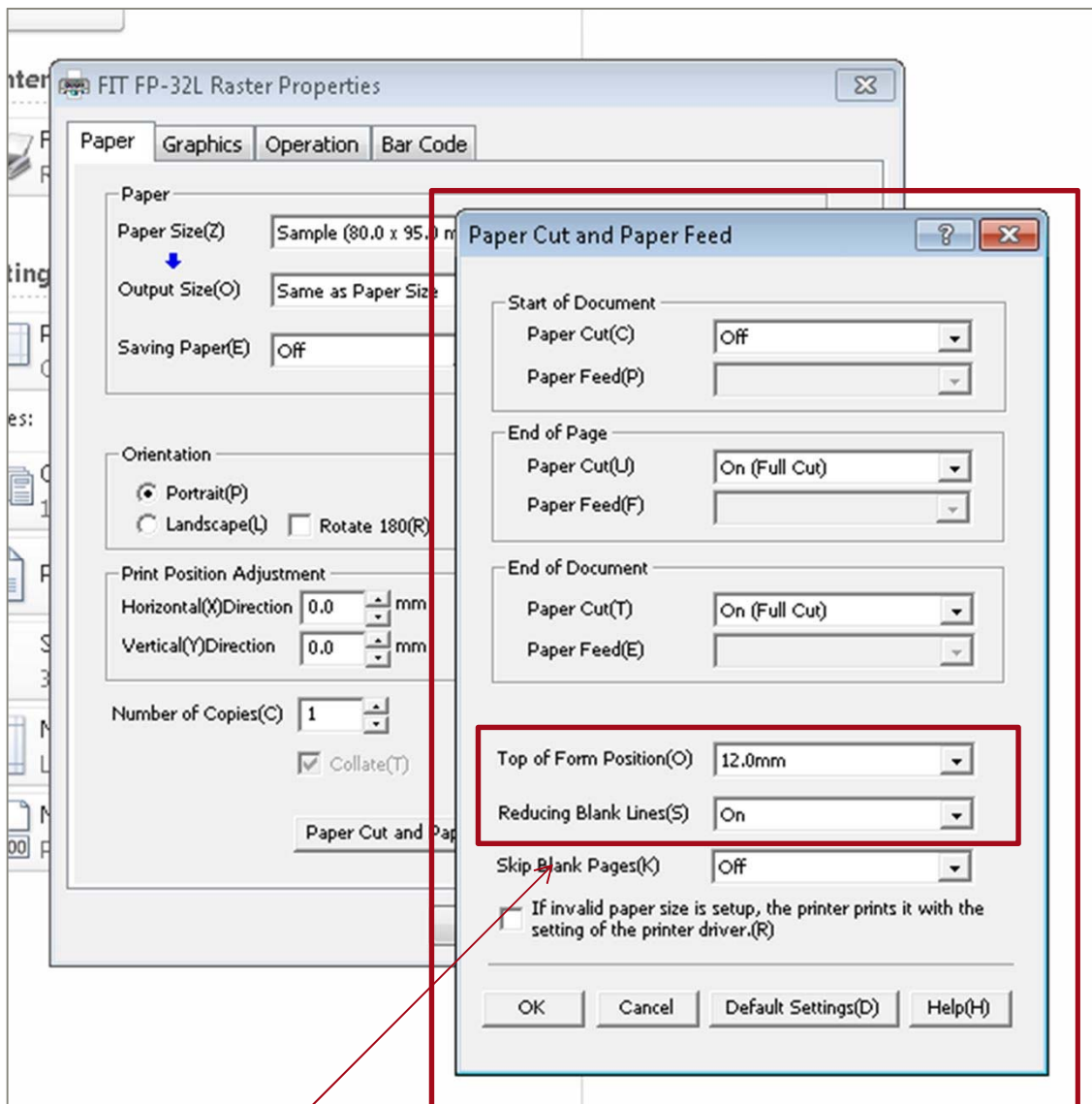

3. Please check the following contents

- Top of Form Position (O)
- Reducing Blank Lines (S)

※Default : Top of Form Position →12.0mm
Reducing Blank Lines →On

Example

※ Top of Form Position
12.0mm → 1.5mm

Paper Cut and Paper Feed

Start of Document

Paper Cut(C) Off

Paper Feed(F) On (Full Cut)

End of Document

Paper Cut(T) On (Full Cut)

Paper Feed(E) On

Top of Form Position(O) 1.5mm(Priority is quality)

Reducing Blank Lines(S) On

Skip Blank Pages(K) Off

☐ If invalid paper size is setup, the printer prints it with the setting of the printer driver.(R)

OK Cancel Default Settings(D) Help(H)

The margin space becomes reduced in size.

Sakura Kobayashi (Ms.)
Global Sales and Marketing Div.
Fujitsu Isotec Ltd.
Adr: 135, Higashinozaki, Hobara-machi,
Date-shi, Fukushima,960-0695 JAPAN
Tel: +81-24-574-2236 (COINS:7387-2594)
Fax: +81-24-574-2382
E-mail: kobayashi.saku@jp.fujitsu.com

Example

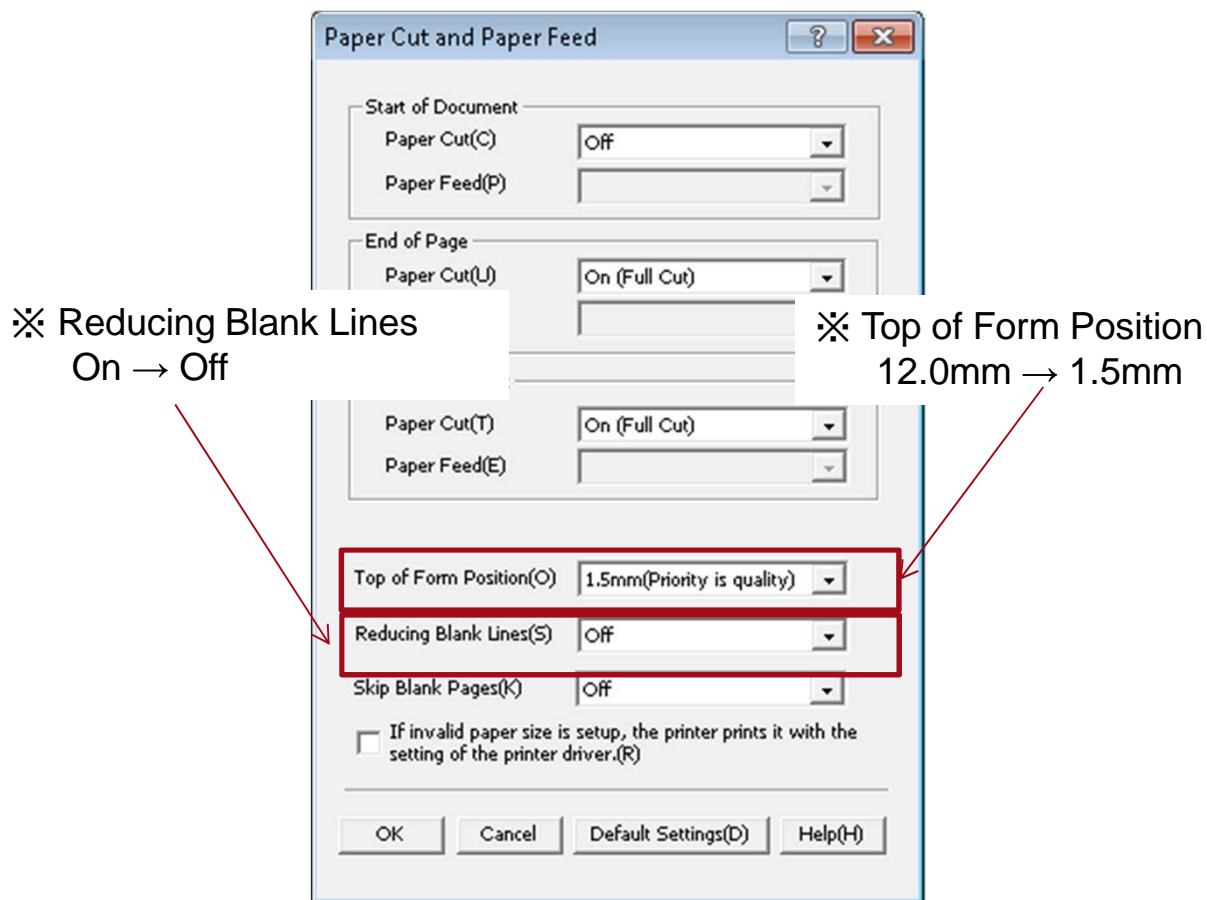

Specifications



Print Method	Direct Line Thermal Recording Method
Print Resolution	8dot/mm (203 dpi)
Print Speed	
One color	Up to 260mm/second (69 lps) *1 (58 ~ 83mm paper width) Up to 140mm/second (37 lps) *1 (38 ~ 57mm paper width) Up to 80mm/second (21 lps) *1 (25.4 ~ 37mm paper width)
Two color	Up to 115mm/second (30 lps) *1
Line feed	3.75mm (Standard), Programmable 0 ~ 900mm
Paper Feed-out Direction	Front feed out
Auto cutter	Full-cut cutter (Standard) Programmable Partial-cut and Full-cut cutter (Factory option)
Auto cutter position	12mm(Standard) or Programmable 1.5mm distance between cutter and top of form
Paper specification	
Paper thickness	75µm(0.075mm) ~ 150 µm(0.150mm)
Roll diameter	Up to φ102mm (Paper thickness : 75 ~ 150µm)
Maximum Print Width	
25.4mm width paper	20mm(160dots)
70mm width paper	64mm(512dots)
80mm width paper	64mm(512dots) or 72mm(576dots)
83mm width paper	80mm(640dots)
Column and Character	
25.4mm width paper	Font A(13 column), Font B(16/17 column), Font C(20 column)
70mm width paper	Font A(42 column), Font B(51/56 column), Font C(64 column)
80mm width paper	Font A(42 or 48 column), Font B(51/56 or 57/64 column), Font C(64 or 72 column)
83mm width paper	Font A(53 column), Font B(64/71 column), Font C(80 column)
Character set	
1byte	ANK(95 char.), International Character(48 char.), Enlarged Graphics(128 char. X 20 pages), Download Character(95 char.)
2bytes	JIS1&2 Kanji(6879 char.) JISX0208-1990, User-Defined Character(94 char.), Special Characters(845 char.)
Barcode	
One dimension	UPC-A, UPC-E, EAN8, EAN13, CODE39, ITF(Interleaved Two of Five code), CODABAR(NW-7), Code 93, Code 128, GS1-DataBar(RSS), EAN-128(GS1-128)
Second dimension	PDF 417, DataMatrix, Maxi code, QR code
Logo Store	3Mbit (384K byte)
Input voltage	+24VDC±10%
Power Consumption	Standby:3W/0.1A, Operating: Average 44W/1.5A
Paper near end and Paper end sensor	Horizontal usage(Standard)
Reflective paper sensor for Black mark	Standard
Transmissive paper sensor for Die-cut label and notch	Standard
Buzzer	One buzzer (Standard)
Peripheral Drive Circuit	1 port, 2 circuits, Max.1A
Safety and EMC Standard	CSA, UL, TUV, CE mark, CCC, VCCI class A, FCC class A, EN55022 class A (Depend on models)
Dimensions	128mm(W) x 207mm(D) x 145mm(H)
Wight	Approx. 1.9 kg
Interface	
RS232C I/F	RS232C with Power supply (D-SUB 25 pins)
USB I/F	USB2.0 Full speed (Type-B x 1port) and Type-A x 2 ports
Parallel I/F	Centronics IEEE-1284 Nibble Mode Compliance (Anphenol 36 pins)
RS232C + USB I/F	RS232C(D-SUB 9 pins) + USB2.0(Full speed) (Type-B x 1port)
LAN I/F	10 BASE-T/100BASE-TX (RJ-45 x 1port)
Printer Driver	Windows® 2000, Windows Server® 2003, Windows Server® 2008, Windows® XP, Windows Vista®, Windows® 7, Windows Server® 2008 R2 OPOS (V1.10 compliance)
Software Interface	Standard ESC/POSTM
Reliability	
Printer	70 million lines (MCBF) *1
Print head	150km (One color), 75km (Two color) *1
Cutter	2 million cuts (Paper thickness 75µm) *1, 0.5 million cuts(Paper thickness 150µm) *1, 1 million cuts (Die-cut label) *1, 1 million cuts / (Cont. label with cleaning) *1
Operating condition	
Temperature	0°C ~ 40°C
Humidity	10% ~ 95%RH (without condensation, Highest wet bulb temperature:29°C or less)
Storage condition	
Temperature	-20°C ~ 60°C
Humidity	5% ~ 95%RH (without condensation)
RoHS and FUJITSU Environment Assessment	Standard
Options	Roll paper unit (max.φ200mm)

*1 Based on FUJITSU measurement and quality standards.

All specifications are subject to change without notices,

*2 Depending on Language specification

If you have questions, please free to contact to the following contact information .

Fujitsu Isotec Limited.

<Address>

Global Sales and Marketing Div.

Adress: 135, Higashinozaki, Hobara-machi, Date-shi, Fukushima,
960-0695 JAPAN

<Email>

fit-gsm@cs.jp.fujitsu.com

<Tel / Fax>

Tel: +81-24-574-2236

Fax: +81-24-574-2382

<Official web site>

<http://www.fujitsu.com/jp/group/fit/en/index.html>

We are looking forward to hearing from you.

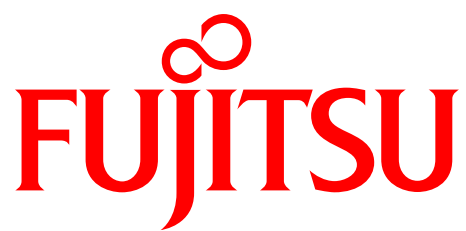

shaping tomorrow with you