

How do I confirm the compatibility of current application?

Answer:

You can confirm the compatibility by the printing from your application after selecting "Command Trace" mode.

If there are incompatibilities, they are traced by invert of black and white characters.

Therefore, it is easy to replacement the printer easily based on this information.

Special Mode

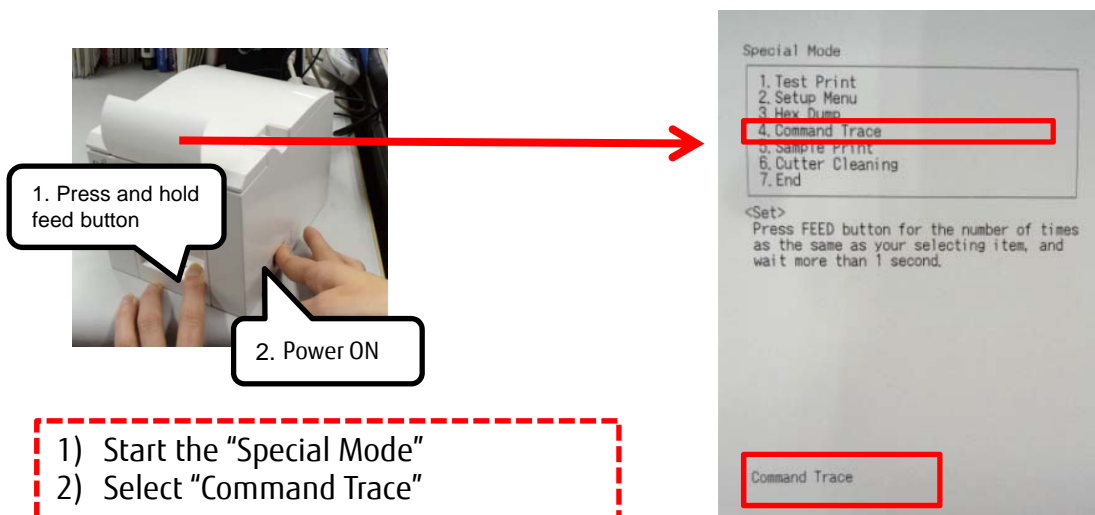

After selecting command trace, please print the data by the current application. The following data is shown to inform the incompatible command. (traced by invert of black and white character.)

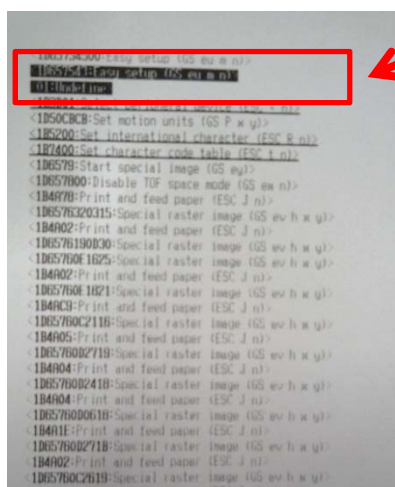

*Example