

# COMPACT POWER RELAY

## 1 POLE - 210A Battery Latching relay

### FTR-V1 Series

#### ■ FEATURES

- 1 pole 210A 1 form B relay for 12V car battery
- Low profile
- Double winding latching relay
- 210A (at 85 °C) / 120A (at 125 °C) continuous current
- Low contact resistance: Max. 0.6mΩ (initial, at 1A)
- Ambient temperature up to 125 °C)
- Plastic sealed
- Plastic material: Conforms to UL94V-0 flammability



#### ■ Applications

Disconnect of battery / capacitor, protection of battery / capacitor, switch of 2 power supplies.

#### ■ PARTNUMBER INFORMATION

[Example]    FTR-V1    U    C    012    W    ST  
                   (a)    (b)    (c)    (d)    (e)    (f)

(a)	Relay type	FTR-V1	: FTR-V1 Series
(b)	Contact configuration	U	: 1b (1 form B)
(c)	Coil type	C	: Dual coil latching
(d)	Coil voltage	012	: 12VDC
(e)	Contact material	W	: Silver alloy
(f)	Special type	ST	: Standard

Actual marking does not carry the type name: "FTR"  
 E.g.: Ordering code: FTR-V1UC012W    Actual marking: V1UC012W

# FTR-V1 SERIES

## ■ SPECIFICATION

Item	FTR-V1		
Contact Data	Configuration	1b (1 form B)	
	Material	Silver alloy	
	Construction	Twin	
	Contact rating	Inrush: 230A 14VDC Break:1A 14VDC	
	Contact voltage drop (initial)	Max. 0.6mV at 1A 6VDC	
	Contact resistance (initial)	Max. 0.6mΩ at 1A 6VDC	
	Continuous current	210A (at 85 degC, cable size 38mm <sup>2</sup> ) 120A (at 125 degC, cable size 38mm <sup>2</sup> )	
	Max. breaking current	500A 12VDC resistive, 1,000 operations	
	Min. switching load *	6VDC, 1A (reference)	
Life	Mechanical	200 x 10 <sup>3</sup> operations	
	Electrical	120 x 10 <sup>3</sup> operations (Inrush :230A 14VDC / Break:1A 14VDC)	
Coil data	Operating ambient temperature range	-40 degC to +125 degC (no frost)	
	Rated power consumption	28.8W (at nominal voltage, at 20 degC)	
	Pulse width	50 to 100ms	
Timing Data	Set (at nominal voltage, at 20 degC)	Max. 10ms (without bounce)	
	Reset (at nominal voltage, at 20 degC)	Max. 10ms (without bounce)	
Insulation	Resistance (initial)	100M Ω at 500VAC	
	Dielectric withstand- ing voltage (initial)	Between open contacts	500VAC(50/60Hz), 1 minute
		Between coil-contact	500VAC(50/60Hz), 1 minute
Other	Vibration resistance	Misoperation	10 to 200Hz, acceleration 45m/s <sup>2</sup> , constant acceleration (Detection 1ms, set/reset)
		Endurance	10 to 200Hz, acceleration 45m/s <sup>2</sup> , constant acceleration (Set/reset, up/down 4 hours, left/right 2 hours)
	Shock resistance	Misoperation	Min. 100m/s <sup>2</sup> (11±1ms) (Detection 1ms, set/reset 36 times each)
		Endurance	Min. 1,000m/s <sup>2</sup> (6±1ms) (Set/reset 36 times total)
	Weight	Approximately 120 g	
	Sealing	Sealed, RT III	

Note: Values of electrical characteristics are under 15 to 35 degC, 25 to 75%RH, air pressure 86kPa to 106kPa (JIS standard condition) unless otherwise specified.

\* : Minimum switching loads mentioned above are reference values. Please perform the confirmation test with actual load before production since reference values may vary according to switching frequencies, environmental conditions and expected reliability levels.

## ■ COIL RATING

Coil Code	Rated Coil Voltage (VDC)	Coil Resistance +/- 10% (Ohm)	Must Set / Reset Voltage (V) *
012	12	5	5.4 (20 °C)
			5.8 (85 °C)
			7.7 (125 °C)

Note: All values in the table are valid for 20°C and zero contact current, unless otherwise stated.

\* Specified operate values are valid for pulse wave voltage.

## ■ CHARACTERISTIC DATA

### Maximum Carrying Current

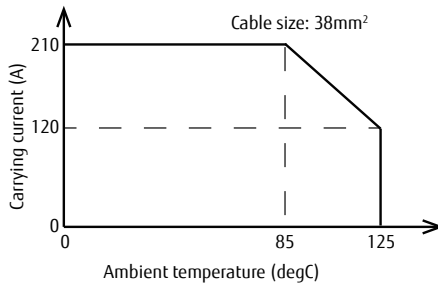

### Distribution of set/reset voltage

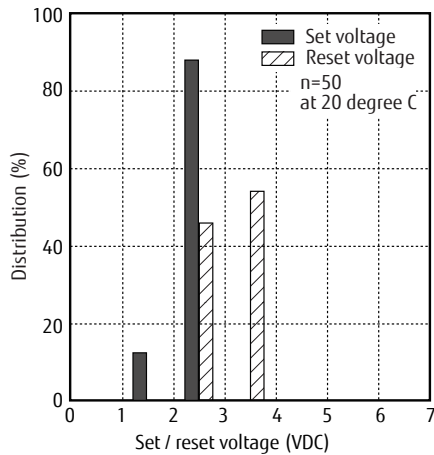

### Distribution of contact voltage drop (contact resistance)

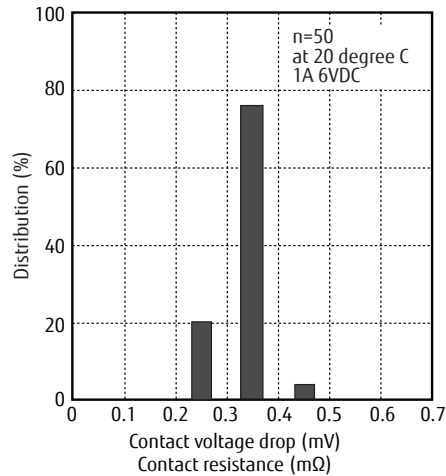

### Distribution of set/reset time

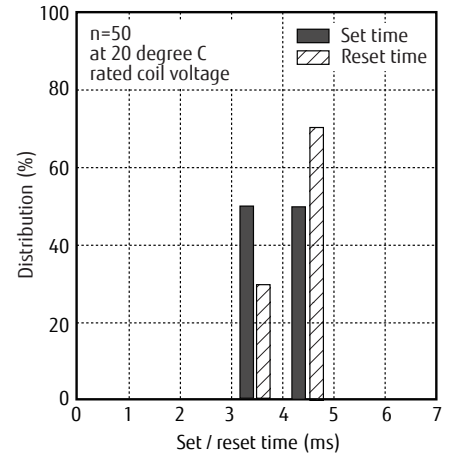

## Shock resistance characteristics

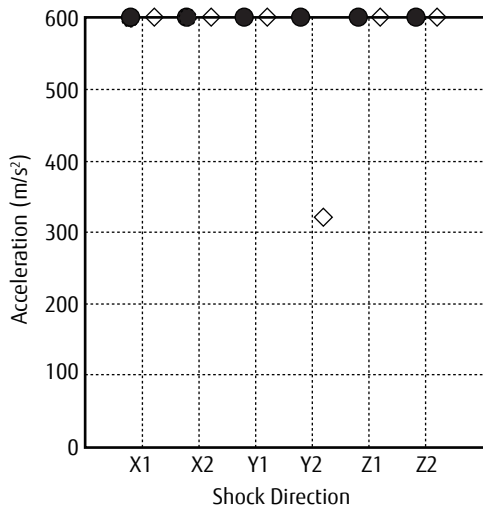

Half sine half wave pulse  
 Shock application time:  $11 \pm 1$ ms  
 Detection level: chatter  $> 1$ ms  
 Shock direction: see below diagram

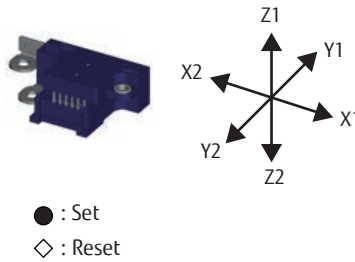

### Notes for latching relay

- Latching relays are shipped in the state set, but state may change due to shock during transportation or mounting. Before using the relays, it is advisable to bring the relays in necessary state (set or reset) and program a circuit sequence. Otherwise, it will or will not operate simultaneously with power activation.
- Please connect relay coils according to specified polarity.
- Do not apply voltage to both set coil and reset coil at a time.

## DIMENSIONS

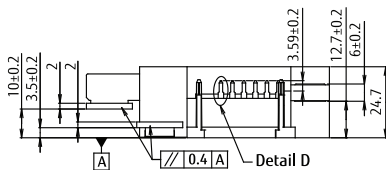
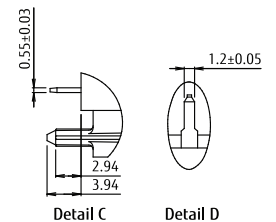
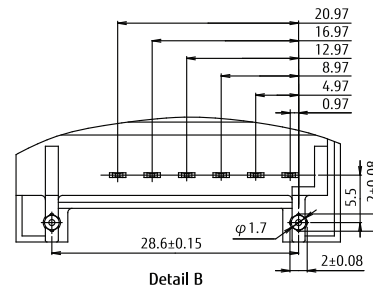
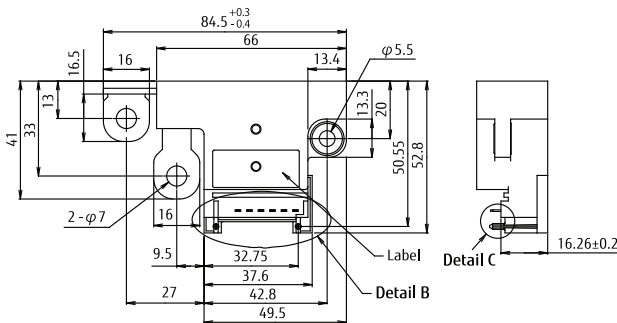

Tolerance :  $\pm 0.3$ mm unless otherwise specified  
 Unit:mm

- **Schematics**  
(BOTTOM VIEW)

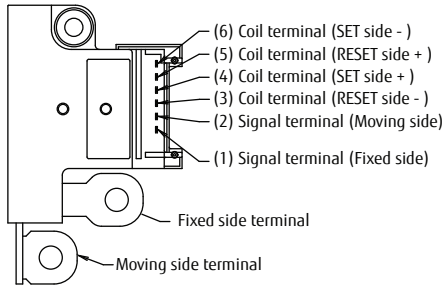

**Circuit Diagram**

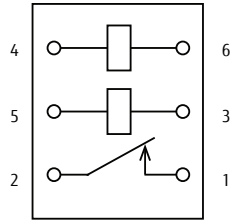

Circuit diagram shows set status.  
Products are shipped in set status

(number) : Terminal number, corresponds to numbers on circuit diagram

Unit: mm

## RoHS Compliance and Lead Free Information

### 1. General Information

- | All automotive relays produced by Fujitsu Components are compliant with RoHS directive 2002/95EC including amendments.
- | Lead free solder plating on relay terminals is Sn-3.0Ag-0.5Cu, unless otherwise specified. This material has been verified to be compatible with PbSn assembly process.

### 2. Recommended Lead Free Solder Profile

- | Recommended solder Sn-3.0Ag-0.5Cu.

**Flow Solder condition:**

Pre-heating: maximum 120°C  
Soldering: dip within 5 sec. at  
260°C solder bath

**Solder by Soldering Iron:**

Soldering Iron  
Temperature: maximum 360°C  
Duration: maximum 3 sec.

**We highly recommend that you confirm your actual solder conditions**

### 3. Moisture Sensitivity

- Moisture Sensitivity Level standard is not applicable to electromechanical relays, unless otherwise indicated.

### 4. Tin Whiskers

- Dipped SnAgCu solder is known as presenting a low risk to tin whisker development. No considerable length whisker was found by our in house test.

## Fujitsu Components International Headquarter Offices

<b>Japan</b> FUJITSU COMPONENT LIMITED Shinagawa Seaside Park Tower 19F, 12-4, Higashi-shinagawa 4-chome, Shinagawa-ku, Tokyo, 140-0002, Japan Tel: (81-3) 3450-1682 Fax: (81-3) 3474-2385 Email: fcl-contact@cs.jp.fujitsu.com Web: www.fujitsu.com/jp/fcl/	<b>Asia Pacific</b> FUJITSU COMPONENTS ASIA, LTD. 102E Pasir Panjang Road #01-01 Citilink Warehouse Complex Singapore 118529 Tel: (65) 6375-8560 Fax: (65) 6273-3021 Email: fcal@sg.fujitsu.com Web: www.fujitsu.com/sg/products/devices/components	<b>Korea</b> FUJITSU COMPONENTS KOREA LIMITED Alpha Tower #403, 645 Sampyeong-dong, Bundang-gu, Seongnam-si, Gyeonggi-do, 13524 Korea Tel: (82) 31-708-7108 Fax: (82) 31-709-7108 Email: fcal@sg.fujitsu.com www.fujitsu.com/sg/products/devices/components/
<b>North and South America</b> FUJITSU COMPONENTS AMERICA, INC 2290 North First Street, Suite 212 San Jose, CA 95131, USA Tel: (1-408) 745-4900 Fax: (1-408) 745-4970 Email: components@us.fujitsu.com Web: us.fujitsu.com/components	<b>China</b> FUJITSU ELECTRONIC COMPONENTS (SHANGHAI) CO., LTD. Unit 4306, InterContinental Center 100 Yu Tong Road, Shanghai 200070, China Tel: (86-21) 3253 0998 Fax: (86-21) 3253 0997 Email: fcal@sg.fujitsu.com Web: www.fujitsu.com/sg/products/devices/components	
<b>Europe</b> FUJITSU COMPONENTS EUROPE B.V. Diamantlaan 25 2132 WV Hoofddorp Netherlands Tel: (31-23) 5560910 Fax: (31-23) 5560950 Email: info@fceu.fujitsu.com Web: www.fujitsu.com/uk/components	<b>Hong Kong</b> FUJITSU COMPONENTS HONG KONG CO., LTD Unit 506, Inter-Continental Plaza No.94 Granville Road, Tsim Sha Tsui, Kowloon, Hong Kong Tel: (852) 2881-8495 Tex: (852) 2894-9512 Email: fcal@sg.fujitsu.com Web: www.fujitsu.com/sg/products/devices/components/	

©2016 Fujitsu Components Europe B.V. All rights reserved. All trademarks or registered trademarks are the property of their respective owners.

The contents, data and information in this datasheet are provided by Fujitsu Component Ltd. as a service only to its user and only for general information purposes.

The use of the contents, data and information provided in this datasheet is at the users' own risk.

Fujitsu has assembled this datasheet with care and will endeavor to keep the contents, data and information correct, accurate, comprehensive, complete and up to date.

Fujitsu Components Europe B.V. and affiliated companies do however not accept any responsibility or liability on their behalf, nor on behalf of its employees, for any loss or damage, direct, indirect or consequential, with respect to this datasheet, its contents, data, and information and related graphics and the correctness, reliability, accuracy, comprehensiveness, usefulness, availability and completeness thereof.

Nor do Fujitsu Components Europe B.V. and affiliated companies accept on their behalf, nor on behalf of its employees, any responsibility or liability for any representation or warrant of any kind, express or implied, including warranties of any kind for merchantability or fitness for particular use, with respect to these datasheets, its contents, data, information and related graphics and the correctness, reliability, accuracy, comprehensiveness, usefulness, availability and completeness thereof. Rev. July 20<sup>th</sup>, 2016