

MEMORY CARD CONNECTORS (JEIDA CONFORMABLE)

560H SERIES DRAM CARD CONFORMING TO Ver. 1

■ FEATURES

- These connectors conform to the Japan Electronic Industry Development Association (JEIDA) DRAM card Ver. 1.0 and Joint Electron Device Engineering Council (JEDEC) standards for 88 pin connectors.
- Contact pitch of 1.0 mm (0.039 in.) x 1.27 mm (0.050 in.). Contacts are arranged in a staggered placement. Incorrect insertion can be prevented. Hot system plugging is possible.
- A raised mounting type connector (under which components with a height of 4.5 mm (0.177 in.) maximum can be mounted) is also available.
- The socket is of the SMT type. It is a straddle-type socket for PC board double-sided mounting.

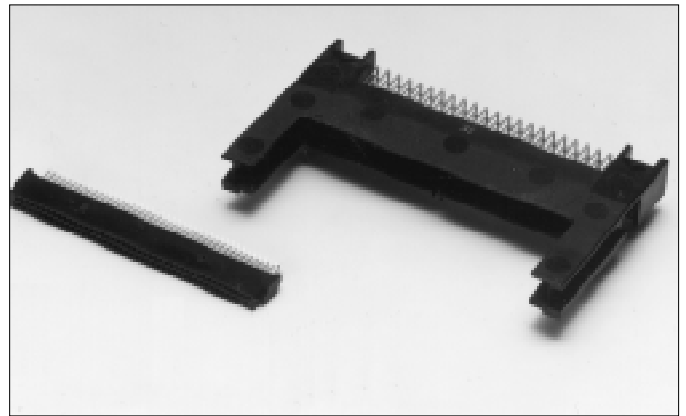

■ SPECIFICATIONS

Item	Specification
Operating temperature range	- 55°C to + 85°C
Current rating	DC 0.5 A
Voltage rating	AC 250 V
Contact resistance	40 mΩ max (6 VDC, 0.1 A)
Insulation resistance	1000 MΩ min. (500 VDC)
Dielectric withstanding voltage	500 VAC for 1 minute
Insertion/withdrawal life	Industrial environment: 100 times Office environment: 200 times

■ MATERIALS

Item	Specification
Insulating material	Plug and socket: PPS (UL94V-0) Copper alloy
Conductor	Contact: Gold over palladium over nickel (PAGOS)
Plating	Terminal: Palladium

560H Series DRAM Card Ver. 1 Conformable

RIGHT-ANGLE PLUG, THROUGH HOLE TYPE

■ DIMENSIONS

Part number: FCN-565R088-G/0

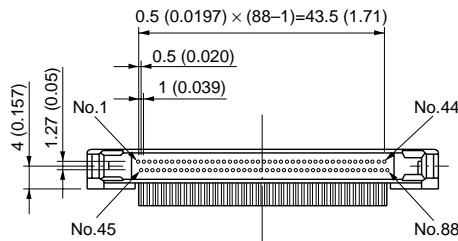
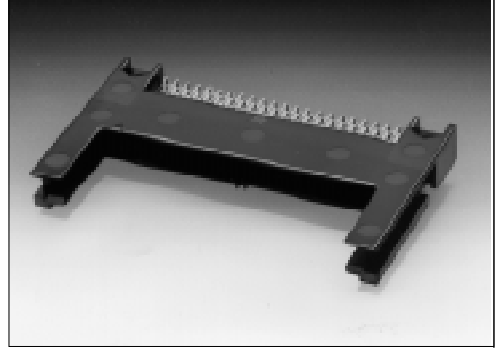
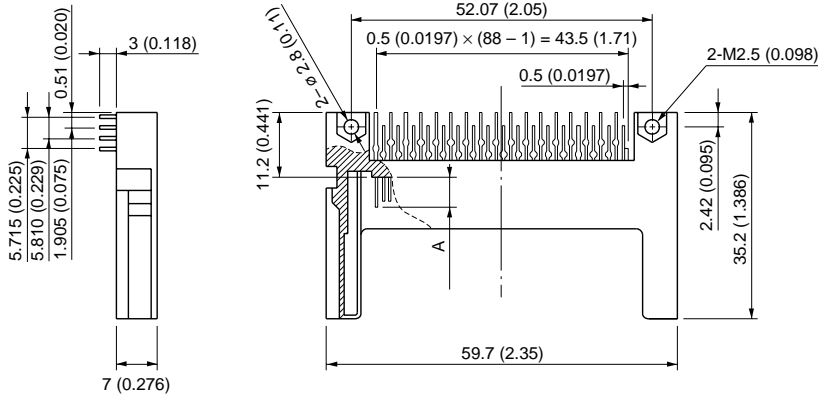

Pin No.	Dimension A	Remarks
1, 9, 11, 15, 17, 25, 27, 35, 37, 44, 45, 56, 63, 67, 73, 88	4.6 (0.181)	Power, ground
Other pins	3.8 (0.150)	Signal pins

A model with a guide is also available. Part number: FCN-565R088-G/034

Unit: mm (in.)

■ PC BOARD MOUNTING HOLE LAYOUT (MOUNTING SIDE)

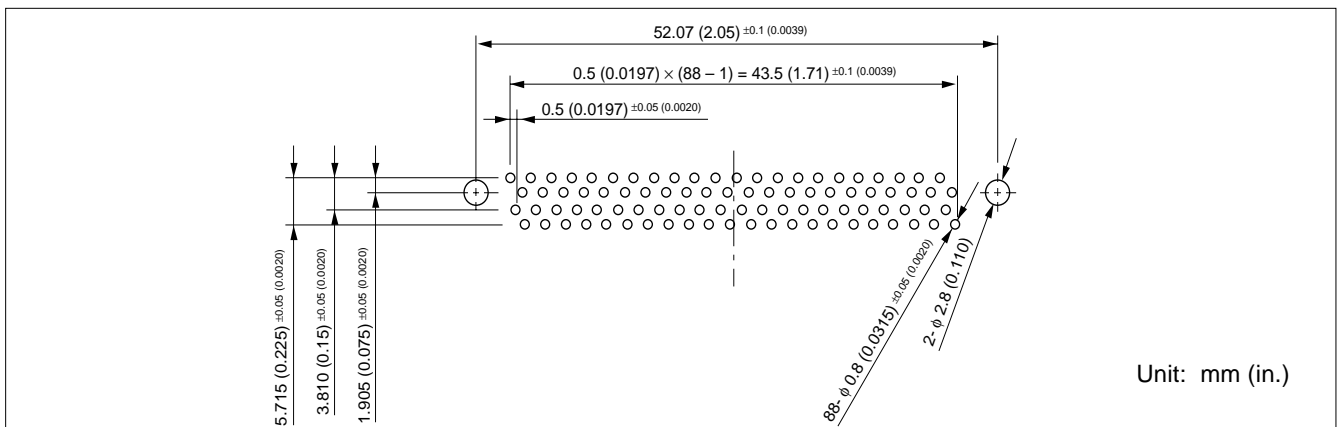

Unit: mm (in.)

560H Series DRAM Card Ver. 1 Conformable

RIGHT-ANGLE PLUG, THROUGH HOLE TYPE (RAISED MOUNTING TYPE)

■ DIMENSIONS

Part number: FCN-565R088-G/A

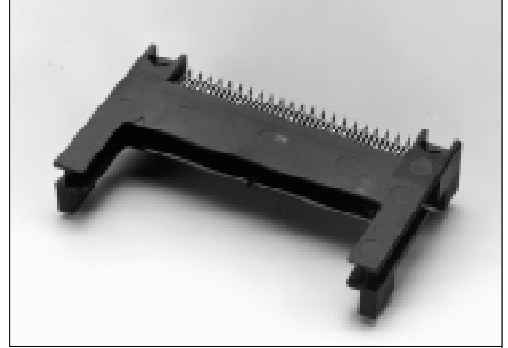
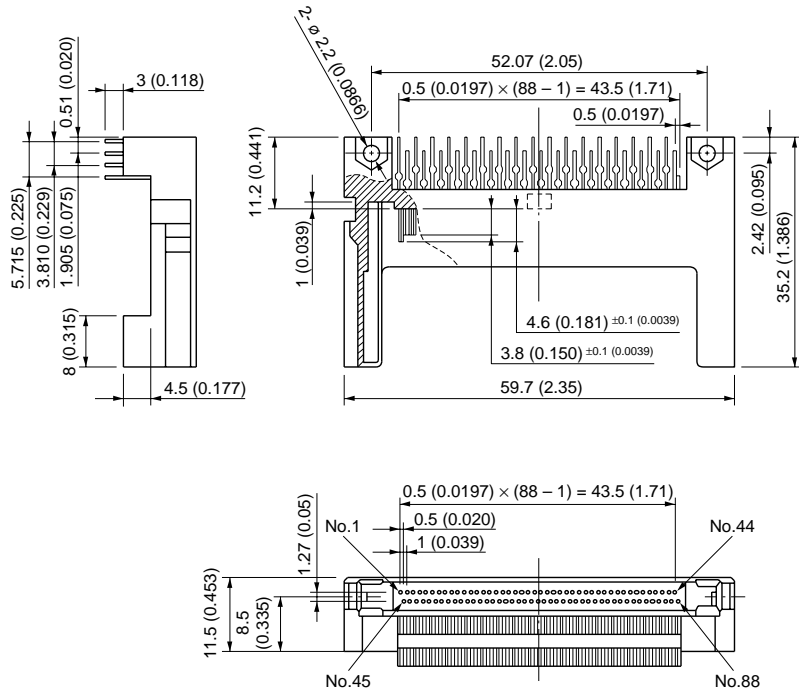

Pin No.	Dimension A	Remarks
1, 9, 11, 15, 17, 25, 27, 35, 37, 44, 45, 56, 63, 67, 73, 88	4.6 (0.181)	Power, ground
Other pins	3.8 (0.150)	Signal pins

Unit: mm (in.)

■ PC BOARD MOUNTING HOLE LAYOUT (MOUNTING SIDE)

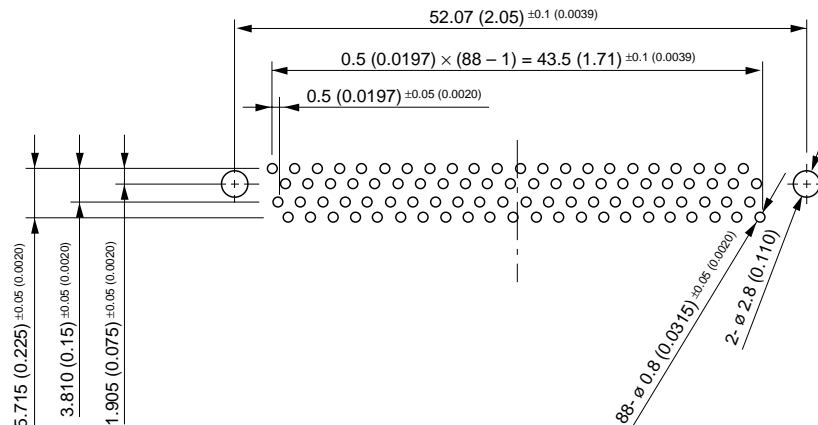

Screws: M2.5 mm (0.098 in.) x 5 mm (0.197 in.) thread self-tapping screws (when 1.6 mm (0.063 in.) thick PC board is used) are recommended.

Unit: mm (in.)

560H Series DRAM Card Ver. 1 Conformable

SOCKET (DOUBLE-SIDED SMT TYPE, PC BOARD STRADDLE)

■ DIMENSIONS

Part number: FCN-568D088-G/0

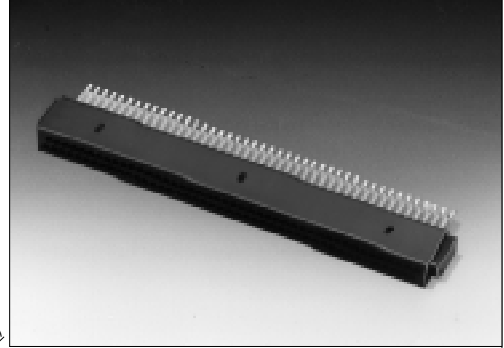
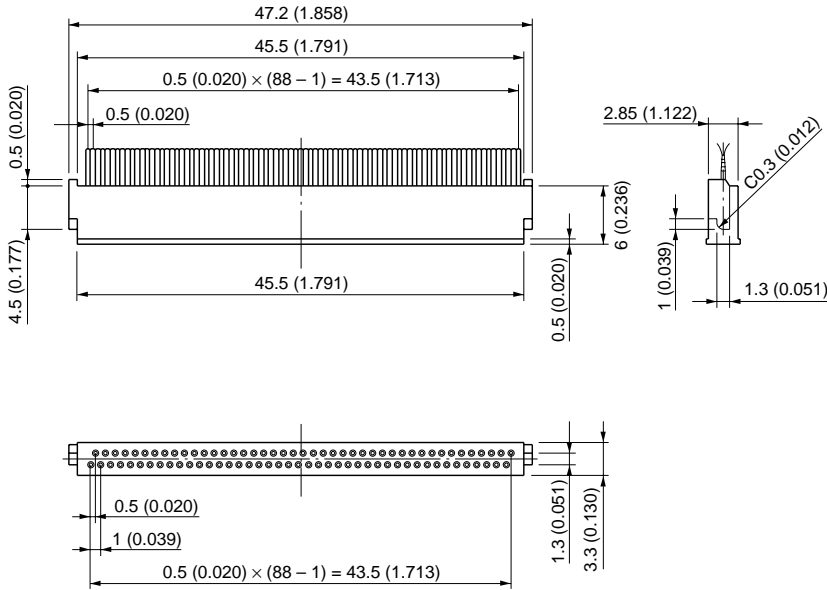

Unit: mm (in.)

■ PC BOARD MOUNTING PATTERN

(PC BOARD THICKNESS INCLUDING PADS: 0.3 mm (0.012 in.) to 0.54 mm (0.021 in.))

■ CROSS-SECTION

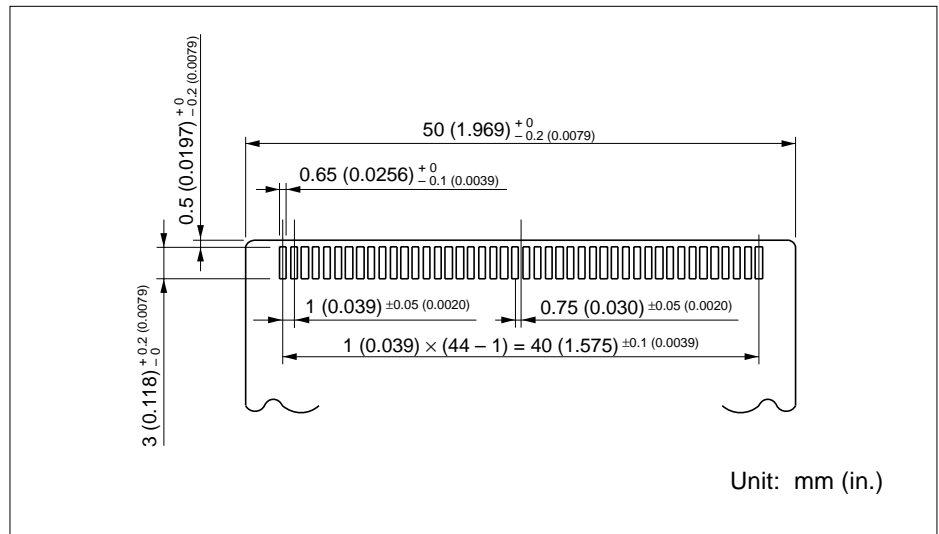
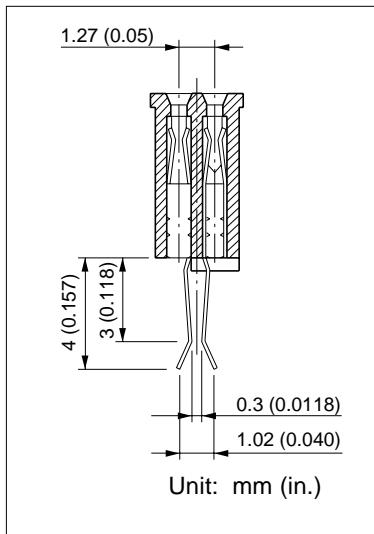

Unit: mm (in.)

560H Series DRAM Card Ver. 1 Conformable

Fujitsu Components International Headquarter Offices

Japan

Fujitsu Component Limited
Gotanda-Chuo Building
3-5, Higashigotanda 2-chome, Shinagawa-ku
Tokyo 141-0022, Japan
Tel: (81-3) 5449-7010
Fax: (81-3) 5449-2626
Email: promothq@fcl.fujitsu.com
Web: www.fcl.fujitsu.com

North and South America

Fujitsu Components America, Inc.
250 E. Caribbean Drive
Sunnyvale, CA 94089 U.S.A.
Tel: (1-408) 745-4900
Fax: (1-408) 745-4970
Email: components@us.fujitsu.com
Web: <http://us.fujitsu.com/components>

Europe

Fujitsu Components Europe B.V.
Diamantlaan 25
2132 WV Hoofddorp
Netherlands
Tel: (31-23) 5560910
Fax: (31-23) 5560950
Email: info@fceu.fujitsu.com
Web: emea.fujitsu.com/components

Asia Pacific

Fujitsu Components Asia Ltd.
102E Pasir Panjang Road
#01-01 Citilink Warehouse Complex
Singapore 118529
Tel: (65) 6375-8560
Fax: (65) 6273-3021
Email: fcal@fcal.fujitsu.com
www.fcal.fujitsu.com

© 2007 Fujitsu Components America, Inc. All rights reserved. All trademarks or registered trademarks are the property of their respective owners. Fujitsu Components America, Inc. or its affiliates do not warrant that the content of the datasheet is error free. In a continuing effort to improve our products, Fujitsu Components America, Inc. or its affiliates reserve the right to change specifications/datasheets without prior notice. Rev. November 2, 2007.