

RECOVERY CD QUICK GUIDE

(for Windows 9x, Me or 2000)

The Recovery CD contains a backup copy of operating system installed with the system. It provides options to re-install your operating system.

LifeBook with built-in CD-ROM



1 Power up the LifeBook.

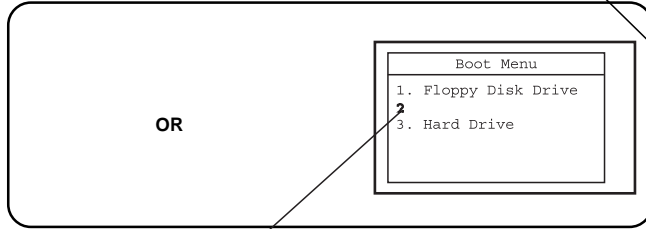

2 Press F12 to access boot sequence and select CD-ROM as boot device.
OR
Press F2 to enter BIOS setup and change boot sequence to CD-ROM.

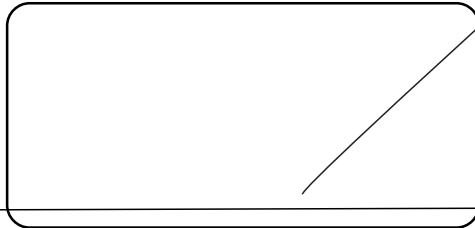

3 Insert the Recovery CD into the CD-ROM drive.

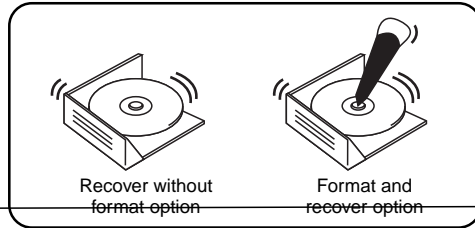

4 Select the recovery options.

LifeBook with PCMCIA CD-ROM

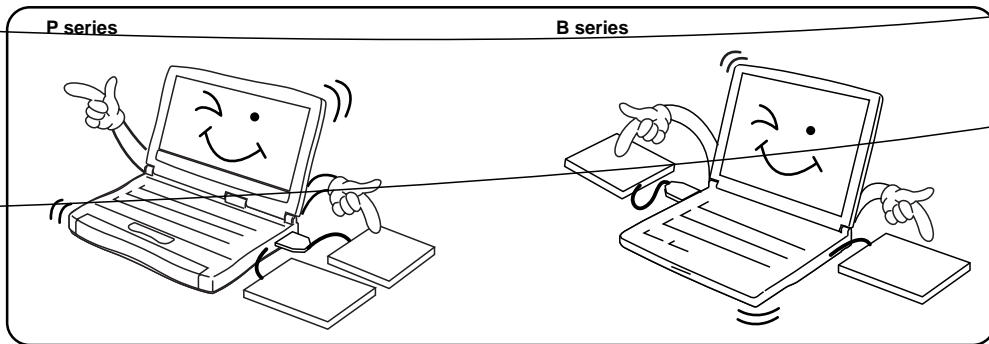

1 Connect your Floppy Drive & CD-ROM

- If the model does not come with above accessories, you may purchase them separately. For optimum performance, Fujitsu accessories is recommended.
- PCMCIA CD-ROM is not bootable. Please use boot floppy as boot device.

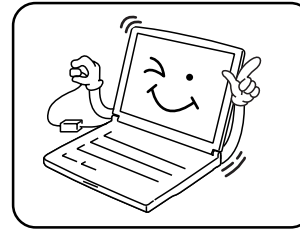

2 Power up the LifeBook.

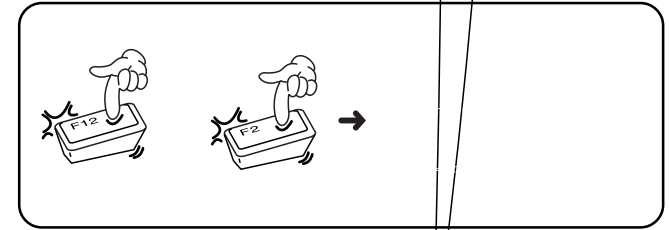

3 Press F12 to access boot sequence and select Floppy Disk Drive as boot device.
OR
Press F2 to enter BIOS setup and change boot sequence to Floppy Disk Drive.

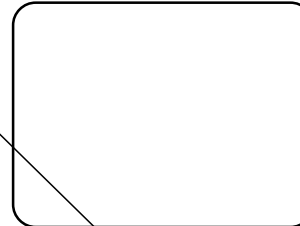

4 Insert the Recovery boot floppy into your floppy drive.

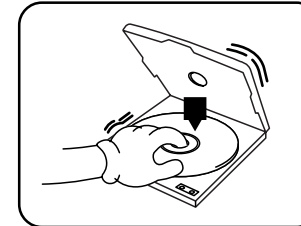

5 Insert the Recovery CD into the CD-ROM drive.

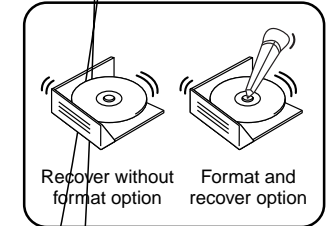

6 Select the recovery options.

DESKPOWER

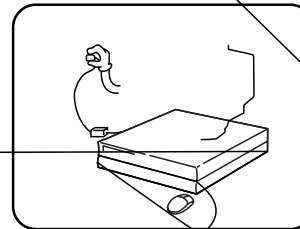

1 Power up the DESKPOWER.

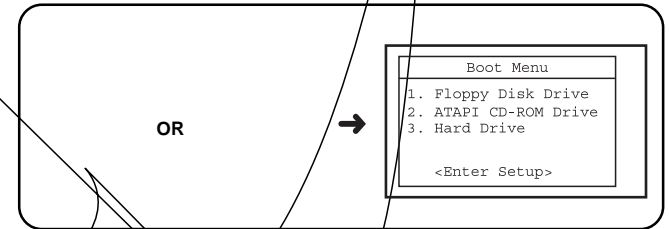

2 Press F12 to access boot sequence and select CD-ROM as boot device.
OR
Press F2 to enter BIOS setup and change boot sequence to CD-ROM.



3 Insert the Recovery CD into the CD-ROM drive.

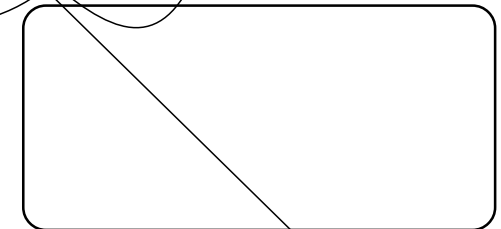

4 Select the recovery options.

NOTE:

- Always backup your important data before perform the recovery.
- Format and recover option will erase your hard disk content including data files. Choose Recover without format will not erase your hard disk content.
- Do not perform recovery unless the operating system encounter critical errors.
- You may use Composite/Driver CD to reinstall device driver or pre-installed program during or after the recovery process.

